

# VirtualEMS Frequently Asked Questions

**Q) What is Setup Type and why do I have to specify one when looking for a room?**

1) Every room has at least one standard Setup Type and many rooms can be configured in multiple ways. Each Setup Type can have a different minimum and maximum capacity. Here are the standard Setup Types:

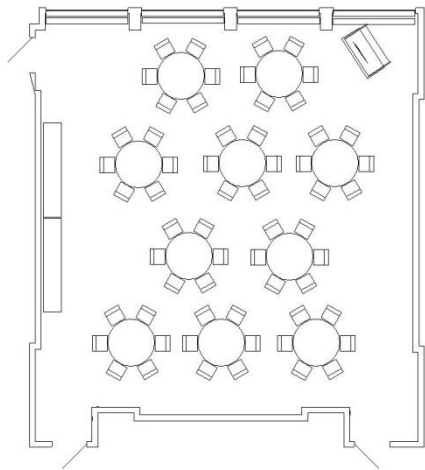

Banquet – round tables & chairs

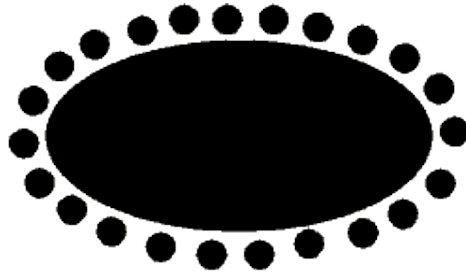

Boardroom – single permanent table surrounded by chairs

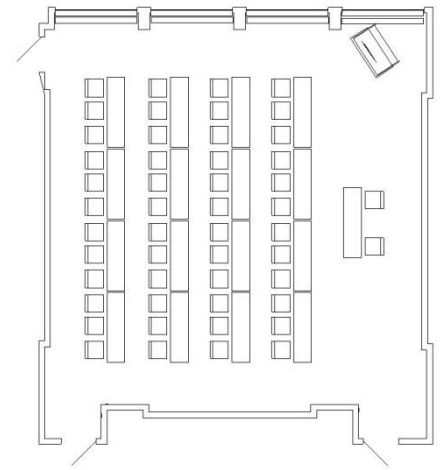

Classroom – tables & chairs

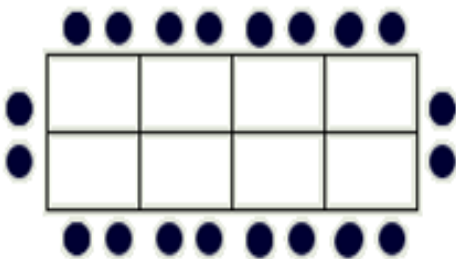

Conference – multiple tables used to form one large table

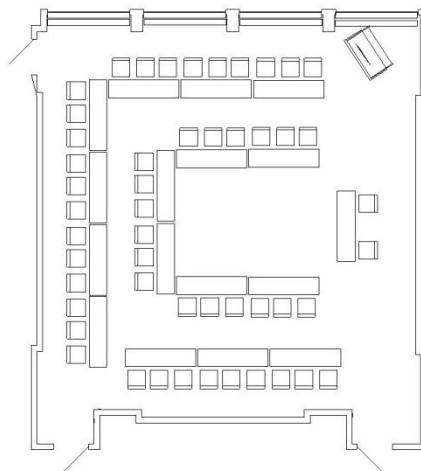

Double U – tables & chairs

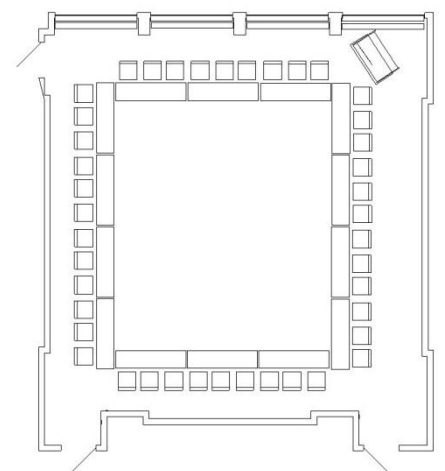

Hollow Square – tables & chairs in a square shape

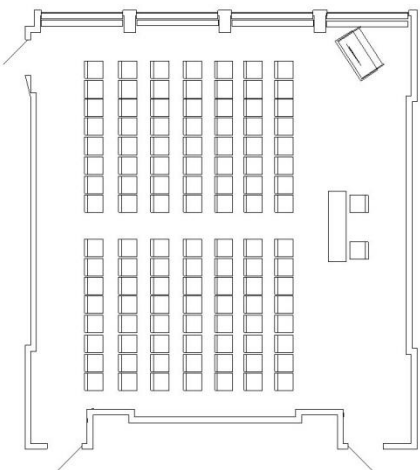

Theater – chairs in a row

2) Additional Setup Types:

Empty – no tables or chairs in the room

To Be Determined – unsure at this time, but will complete a diagram at a later date

3) When you choose a Setup Type in VirtualEMS, you will only be presented with the rooms that have been configured with that Setup Type. *For example, if you choose Boardroom, you will **only** be presented with Taylor 303, 307, 311, Warren 403 or Festival Conference Room 5.*

4) For more information concerning maximum capacities for each Setup Type, see “**Room Setup Standards**” under the **Help** menu.